

Year 5 Maths

Previous learning

- Short multiplication
 - Fractions of amounts
 - Converting fractions
 - Translating shapes
 - Roman Numerals
- Answer questions about a line graph
- Estimating
 - Rounding numbers
 - Quadrilaterals
 - Symmetry
 - Converting time

Addition and subtraction

$$\begin{array}{r} 7435 \\ + 2466 \\ \hline 9901 \\ \hline 111 \end{array}$$

$$\begin{array}{r} 34520 \\ - 679 \\ \hline 33841 \\ \hline 111 \end{array}$$

Key categories and concepts

- Number and place value
- Addition and subtraction
- Multiplication and division
- Fractions
- Measurement
- Geometry- shapes
- Geometry- Position and direction
- Statistics

Number and place value

HTh	TTh	Th	H	T	O
●		●●	●●●	●●●	●●
1	0	2	3	2	0

One hundred and two thousand, three hundred and twenty



Multiplication and division

Th	H	T	O
	2	0	5

Multiply by 10, 100, 1000

$$205 \times 10 = 2,050$$

HTh	TTh	Th	H	T	O
	1	6	0	0	0

$$16,000 \div 100 = 160$$

Divide by 10, 100, 1000

Fractions decimals percentages

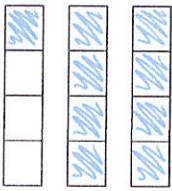

$$2\frac{1}{4} = \frac{9}{4}$$

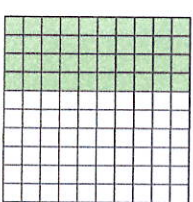

$$\frac{2}{10} = \frac{1}{5} = 0.2$$

$$\frac{16}{9} - \frac{8}{9} = \frac{8}{9}$$

$$2 \times \frac{3}{11} = \frac{6}{11}$$

Ones	Tenths	Hundredths
0	2	3

Measurement

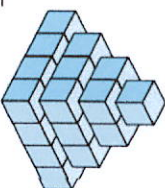
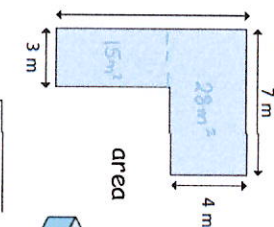

area
43m²
30cm³

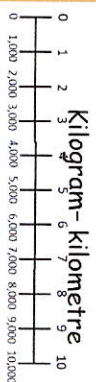

1 pint ≈ 568 ml

Statistics

Location	1st bus	2nd bus
Bus station	10:30	12:15
High Street	10:42	12:27
Green Lane	10:45	12:30
School	10:56	12:41
Four Lane End	11:07	12:52
Library	11:12	12:57
Train station	11:25	13:10

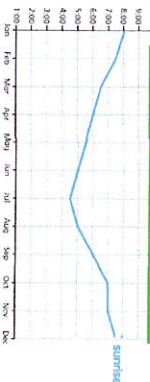

Properties of shapes

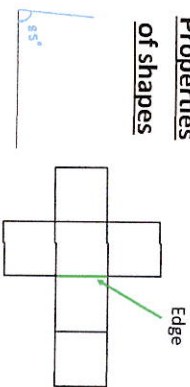

The faces of a cube are all squares.

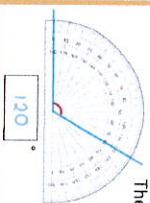

Position and direction

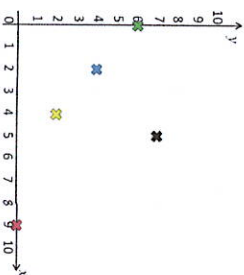

- (2, 4)
- (5, 7)
- (0, 6)
- (9, 0)

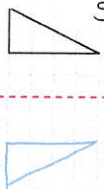

reflection

Key Vocabulary

Improper fraction	A fraction with a higher amount in the numerator
Prime number	A number which can only be divided by itself and 1
Square number	The answer of a number which has been multiplied by itself
Cube number	A number multiplied by itself three times
Factor	Numbers which are multiples within a number
Common Factor	When two numbers share the same factor
Non-unit fraction	A fraction with a higher amount in the numerator
Metric unit	Units based on the metre, gram or second and decimals
volume	The amount of space an object or liquid takes up
net	A 3d shape which has been opened up to lay flat.